

STATE OF NEBRASKA
DEPARTMENT OF TRANSPORTATION
ADDENDUM NO. 3
AND
ELECTRONIC BIDDING SYSTEM
AMENDMENT NO. 3
PROJECT NO. NH-75-2(128)
CONTROL NO. 21209
CALL NO. 200
US-75, MURRAY - PLATTSMOUTH
LETTING DATE: NOVEMBER 19, 2020

The Schedule of Items is amended as follows:

1. In Group 1, the quantity for bid item "Salvaging And Placing Topsoil" is incorrect and should read 775,198.000 SY.
2. In Group 1, the bid item "Water For Dust Control" has been added with a quantity of 3,000.000 MGAL.
3. In Group 3, the bid item "Crushed Rock For Temporary Surfacing" has been added with a quantity of 200.000 TON.
4. In Group 4, the bid item "Crushed Rock For Base Course" has been eliminated.
5. In Group 4, the bid item "Crushed Rock For Base Course" has been added with a quantity of 117.850 CY.
6. In Group 8B, the quantity for bid item "Pull Box, Type PB-5" is incorrect and should read 8.000 EACH.
7. In Group 8B, the quantity for bid item "1 ½-Inch Conduit In Trench" is incorrect and should read 11,116.000 LF.
8. In Group 8B, the quantity for bid item "Street Lighting Cable, No. 6 BARE" is incorrect and should read 12,900.000 LF.
9. In Group 8B, the quantity for bid item "Street Lighting Cable, No. 6 USE" is incorrect and should read 25,508.000 LF.
10. In Group 8B, the bid item "Temporary Traffic Signal At Station 445+21" has been added with a quantity of 1.000 EACH.
11. In Group 8B, the bid item "Temporary Traffic Signal At Station 484+97" has been added with a quantity of 1.000 EACH.
12. In Group 8B, the bid item "Underdeck Luminaire, Type UD-B" has been added with a quantity of 10.000 EACH.

The EBSX generated bid items sheets must show these corrections or the bid will be void.

* * * * *

It should be noted that the plan sheets C1 and C2 will not be revised to reflect these changes. The Project Manager is directed to make these changes as part of the AS BUILT plans.

* * * * *

The Special Provisions are amended to include the following:

CRUSHED ROCK FOR TEMPORARY SURFACING

DESCRIPTION

1. This work will consist of constructing a temporary surface course composed of crushed rock to maintain traffic, at the direction of the Engineer. The Contractor shall furnish, deliver, spread, compact and maintain the crushed rock on an approved subgrade.

MATERIAL REQUIREMENTS

1. Crushed rock shall conform to the requirements of Subsection 1033.02, Paragraphs 1., 2., and 6, and Table 1033.07.

CONSTRUCTION METHODS

1. The Contractor shall deliver crushed rock to the site as directed by the Engineer.
2. The Contractor shall spread crushed rock as directed by the Engineer.
3. The Contractor shall be responsible for the maintenance of the crushed rock as determined by the Engineer.
4. Maintenance may include, but shall not be limited to, the placement and compaction of additional material after initial construction, as directed by the Engineer.
5. When the need for the Crushed Rock for Temporary Surfacing is no longer required, the Contractor shall remove the crushed rock. The crushed rock can be re-used as Crushed Rock Surface Course at the direction of the Engineer. Any remaining material not re-used as Crushed Rock Surface Course shall become the property of the Contractor and removed from the project.

METHOD OF MEASUREMENT

1. The crushed rock will be measured by weight, in tons, determined on approved scales.

BASIS OF PAYMENT

- | 1. Pay Item | Pay Unit |
|--------------------------------------|-----------------|
| Crushed Rock for Temporary Surfacing | Ton (Tn) |

2. Pay Factor:

- a. The Engineer shall take random samples of crushed rock in accordance with the Materials Sampling Guide.
- b. The percentage passing the No. 10 sieve for the samples shall be averaged.
- c. Payment deductions shall be computed using Table 310.01 of the Standard Specifications.
- d. If the material is less than a full lot, but more than 540 tons, than one sample for every 270 tons shall be taken and averaged.
- e. If the material is less than 540 tons, then two samples will be taken and averaged.
- f. The maintenance and removal of Crushed Rock for Temporary Surfacing will not be measured for payment but shall be considered subsidiary to the item "Crushed Rock for Temporary Surfacing."
- g. Payment is full compensation for all work described in this provision.

* * * * *

In Standard Plan 301-R12, on sheet 2 of 3, the 4th sentence under "Concrete Median Surfacing" detail is void and superseded by the following:

All traverse and longitudinal joints shall be filled with joint sealant (Hot Poured).

* * * * *

The plans are amended to include added sheets M13 and M14 as depicted on the attached sheets.

* * * * *

(R1) ADDED SHEET

ROADWAY DESIGN DIVISION

SEC. 13-T12N-R13E

NOTE:

SEE BRIDGE PLANS (STRUCTURE S034 37969 FOR DETAILS OF THE EXISTING CONDUIT SYSTEM IN THE BRIDGE. LIGHTING CONTRACTOR SHALL ROUTE CONDUCTORS THROUGH BRIDGE CONDUIT AND MAKE NECESSARY ELECTRICAL CONNECTIONS TO UNDERDECK LIGHTING UNITS UD-1 THRU UD-10 IN THE JUNCTION BOXES IN THE BRIDGE RAIL. RUN A NO. 6 BARE EQUIPMENT GROUND CONTINUOUS THROUGH THE BRIDGE AND ATTACH TO A GROUND ROD IN PULL BOX 9 AND IN PULL BOX 10 AT EACH END OF THE BRIDGE.

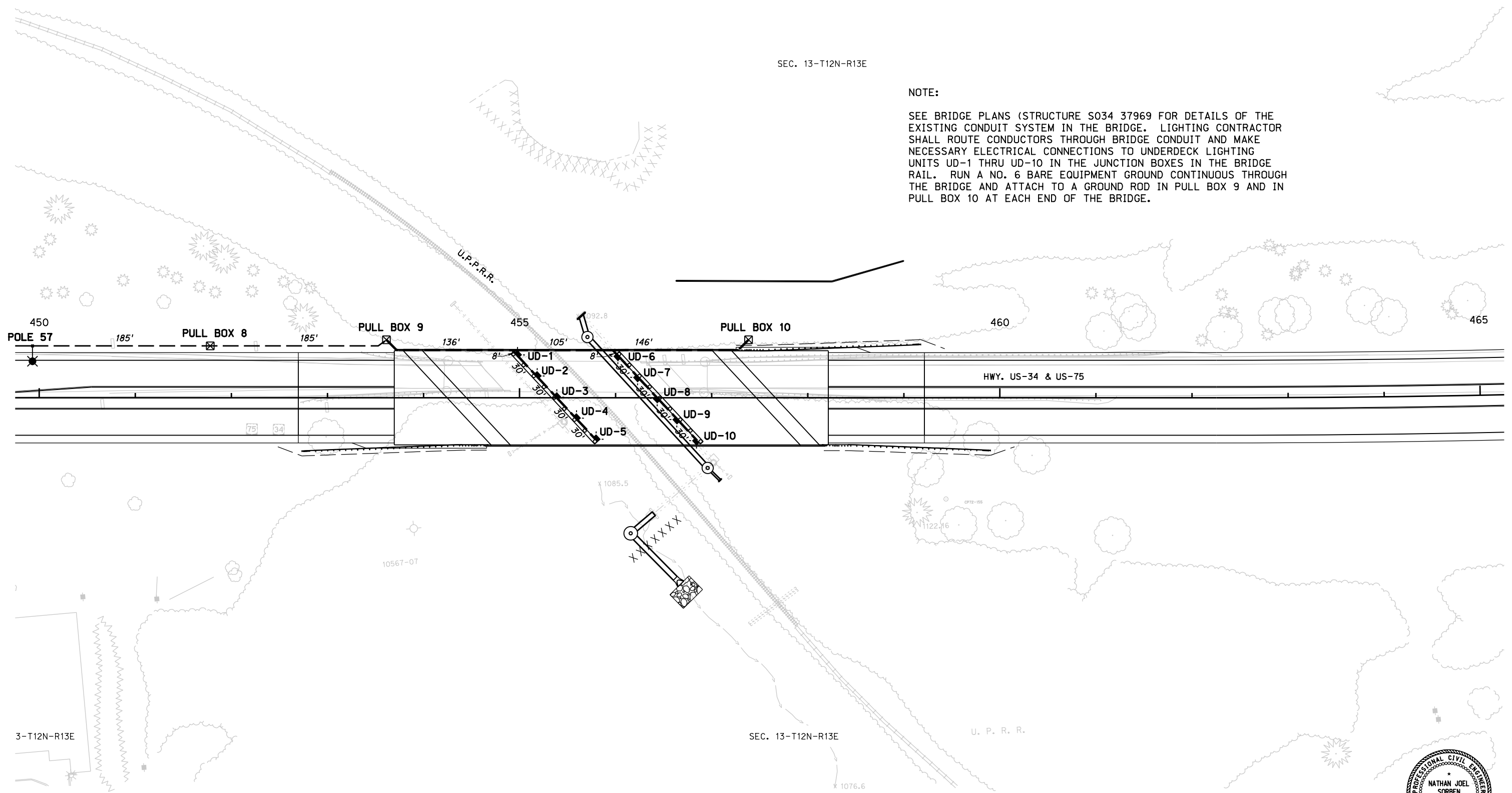

Computer: B604190123

Date: 12-NDV-2020 15:24

File: 212090113 REV 1 ADDED.dgn
 Scale: 1:100

3-T12N-R13E

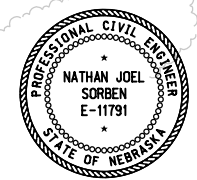

LIGHTING

(R1) ADDED SHEET

**LED UNDERDECK LUMINAIRE SYSTEM
 FOR BRIDGE STRUCTURE S034 37969**

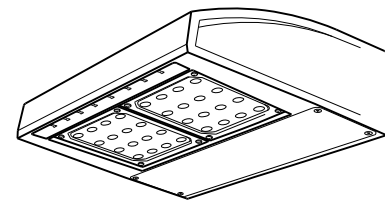

- LUMINAIRE:** LUMINAIRE SHALL BE A LED TYPE WITH A CORRELATED COLOR TEMPERATURE OF 3000K, TOTALLY ENCLOSED, PREWIRED, EQUIPPED FOR SURFACE MOUNTING AND RATED FOR USE IN UL1598 OUTDOOR WET LOCATIONS. HOUSING SHALL BE FINISHED WITH ELECTROSTATICALLY APPLIED POLYESTER POWDER PAINT IN GREY OR BRONZE COLOR; GREY BEING PREFERRED.
- STYLE:** ILLUSTRATION IS TYPICAL OF LED LUMINAIRES COMMERCIALY AVAILABLE AS UNDERDECK LIGHTS. LUMINAIRES OF OTHER DESIGNS AND MEETING PROJECT SPECIFICATIONS ARE EQUALLY ACCEPTABLE.
- MECHANICAL CONSTRUCTION:** LUMINAIRE SHALL HAVE A RUGGED DIE CAST ALUMINUM HOUSING AND A VANDAL RESISTANT LENS OF U.V. STABILIZED POLYCARBONATE OR HEAT AND IMPACT RESISTANT BOROSILICATE GLASS.
- ELECTRICAL:** 120-277 VAC @ 50/60 HZ; SYSTEM POWER FACTOR 90%, 0-10V CONTINUOUS DIMMING; 10KV/5KA SURGE PROTECTION
- OPTICAL ASSEMBLY:** OPTICAL ASSEMBLY SHALL BE DESIGNED TO CONTROL GLARE WHILE PROVIDING AN AVERAGE MAINTAINED HORIZONTAL ILLUMINATION LEVEL OF NO LESS THAN 1.0 FC; AN AVE./MIN. UNIFORMITY RATIO NO GREATER THAN 2.0; A MAX./MIN. UNIFORMITY RATIO NO GREATER THAN 3.5 AND A MAXIMUM BUG RATING OF B2 UO G2 WHEN USING THE FOLLOWING PARAMETERS: ROADWAY WIDTH OF 24 FT.; MOUNTING HEIGHT 24 FT.; LUMINAIRE SETBACK 25 FT.; LUMINAIRE SPACING 30 FT. USE OPPOSITE SIDE LAYOUT AND A MAINTENANCE FACTOR OF 0.83.
- APPROVAL REQUIREMENTS:** ONLY LED UNDERDECK LUMINAIRES LISTED ON THE NDOT "NEBRASKA QUALIFIED MATERIALS VENDORS LIST" WILL BE CONSIDERED FOR USE ON NEBRASKA HIGHWAY LIGHTING PROJECTS. THE "NEBRASKA QUALIFIED MATERIALS VENDORS LIST CAN BE FOUND ON THE NDOT WEBSITE. THE NDOT LIGHTING UNIT WILL VERIFY, VIA COMPUTER SIMULATION, THAT THE LED LUMINAIRE MEETS PROJECT PHOTOMETRIC REQUIREMENTS.
- ACCEPTABLE LUMINAIRE:** UNDERDECK LUMINAIRES CONSIDERED AS MEETING THE ABOVE LISTED REQUIREMENTS AND BEING ACCEPTABLE FOR USE ARE LISTED ON THE "NEBRASKA QUALIFIED MATERIAL VENDORS LIST".

FURNISH AND INSTALL UNDERDECK UNITS OF THE TYPE SHOWN IN THE PLANS. EXCEPT FOR A TOTAL OF APPROXIMATELY 6 FT. OF 3/4" LIQUID TIGHT FLEXIBLE METAL CONDUIT, THE CONDUIT SYSTEMS TO THE UNDERDECK LIGHTS ARE EXISTING. THE CONTRACTOR WILL FURNISH AND INSTALL THE LIQUID TIGHT CONDUIT BETWEEN THE STUBOUT IN THE UNDERSIDE OF THE BRIDGE DECK AND THE STUBOUT IN THE TOP OF THE PIER CAP.

UNDERDECK UNITS WILL BE FED FROM THE STREET LIGHTING CIRCUIT IN THE BRIDGE CURB. TAP THE STREET LIGHTING CIRCUIT IN THE EXISTING JUNCTION BOXES IN THE BRIDGE CURB.

INSTALL CONDUCTORS IN THE EXISTING 3/4" CONDUIT TO THE UNDERDECK LUMINAIRES. PROVIDE APPROVED WEATHERPROOF IN-LINE FUSE HOLDERS WITH FUSES TO THE UNDERDECK CIRCUITS. USE NO. 12 TYPE THWN STRANDED COPPER CONDUCTORS FOR THE PHASE CONDUCTORS AND NO. 12 STRANDED COPPER WIRE (BARE OR GREEN INSULATION) FOR THE EQUIPMENT GROUNDING CONDUCTOR. FUSE THE CIRCUITS IN THE EXISTING JUNCTION BOXES.

METHOD OF MEASUREMENT AND BASIS OF PAYMENT
 UNDERDECK LUMINAIRES, COMPLETE IN PLACE AND ACCEPTED BY THE ENGINEER, SHALL BE MEASURED FOR PAYMENT AS SINGLE UNITS AND WILL BE PAID FOR AT THE CONTRACT UNIT PRICE PER EACH FOR THE ITEM "UNDERDECK LUMINAIRE, TYPE UD-B". THIS PRICE AND PAYMENT SHALL BE FULL COMPENSATION FOR FURNISHING AND INSTALLING THE LUMINAIRE AS DETAILED IN THE PLANS; FOR FURNISHING AND INSTALLING THE 3/4" FLEXIBLE LIQUID TIGHT CONDUIT; FOR ALL NECESSARY CONDUCTORS FROM THE JUNCTION BOX IN THE BRIDGE CURB TO THE LUMINAIRES; FOR ALL FUSES AND FUSE HOLDERS; AND FOR ALL LABOR, MATERIALS, TOOLS, EQUIPMENT AND INCIDENTALS NECESSARY TO COMPLETE THE WORK.

PULL BOX SCHEDULE			
UNIT NO.	STATION	TYPE	REMARKS
PULL BOX 8	451+52-54' LT.	PB-5	☉ HWY. US-34 & US-75
PULL BOX 9	454+61-60' LT.	PB-5	☉ HWY. US-34 & US-75
PULL BOX 10	457+38-60' LT.	PB-5	☉ HWY. US-34 & US-75

UNDERDECK LUMINAIRE, TYPE UD-

UNDERDECK LUMINAIRE SCHEDULE		
UNIT NO.	LOCATION	TYPE
UD-1	SEE BRIDGE PLANS, STRUCTURE S034 37969 AND LIGHTING PLAN SHEET N13	UD-B
UD-2		UD-B
UD-3		UD-B
UD-4		UD-B
UD-5		UD-B
UD-6		UD-B
UD-7		UD-B
UD-8		UD-B
UD-9		UD-B
UD-10		UD-B

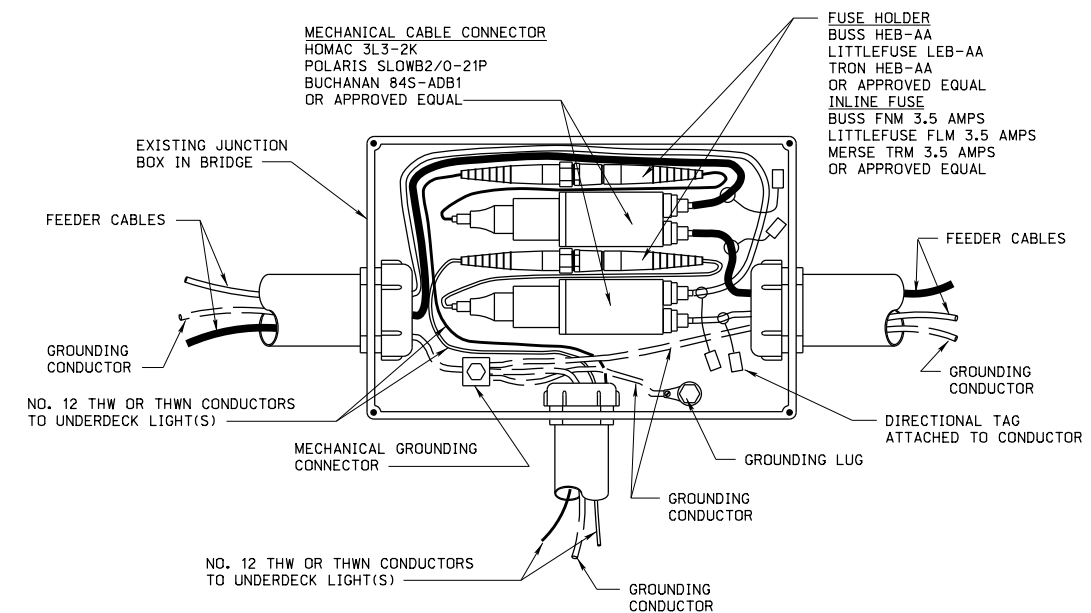

**CONNECTIONS IN JUNCTION BOX
 (TYPICAL)**



Upon execution of the contract, the plans will be revised to reflect these changes.

DEPARTMENT OF TRANSPORTATION

James J. Knott, P.E.
Construction Engineer

Issued:
JJK: 200AD311

NOTICE: Only the contractors issued bidding proposals receive this addendum and responsibility for notifying any potential subcontractors or suppliers remains with the contractor.