

Consulting Geotechnical Engineers
Environmental Science
Construction Management & Inspection
Construction Materials Testing
Hydrogeology/Groundwater Monitoring
Earth Instrumentation Services



5871 New Peachtree Road
Doraville, GA 30340-1084
Phone: 770/457-9776
Fax: 770/457-9964

Chattahoochee Consulting Group, Inc.

March 26, 2020
Project No. 4976.002.20

KAIZEN COLLABORATIVE
2390 Main Street
Tucker, Georgia 30084

Attention: Ms. Michelle Biggs

RE: Report of Laboratory Analyses
Newnan Centre Linc Trail
Newnan, Georgia

Dear Michelle:

The purpose of this study was to collect soil samples for analytical testing along northeast side of the pond where a new fence is currently proposed. Representative samples were collected at the locations requested in Exhibit A. Four of the samples were collected from the near surface (i.e. <12 inches) and a fifth sample, along the proposed bridge abutment was collected from a depth of approximately 4 feet below existing grades. The approximate sample locations are shown on the attached Sample Location Plan, Figure 1. The samples were obtained using a hand auger which was decontaminated between samples using a water and LiqueX™ mixture.

The samples were submitted for RCRA Metal (Method 6010B) and PAH (Method 8270C) analyses. The laboratory results indicated the presence of both PAH's and RCRA Metals in very low concentrations which were generally below the HSRA Notification Levels. A notable exception was in test location S-1 at the south end of the pond, near the existing houses. In this sample, Arsenic was determined to be present at a concentration slightly greater than the HSRA Notification Level. The result for this sample is tabulated below:

Sample ID	Sample Depth (ft.)	Constituent	Detected Concentration (ppm)	HSRA Notification Level (ppm)
S-1	< 1	Arsenic	43.9	41

Based on the results of the laboratory testing, the Arsenic level of 43.9 ppm found in sample S-1 is just above the HSRA Notification Level of 41 ppm. The complete laboratory test results are attached.

We have enjoyed working with you on this project. If you have any questions, please feel free to contact this office.

Sincerely,

CHATTAHOOCHEE CONSULTING GROUP, INC.

William T. Sheppard
Project Engineer



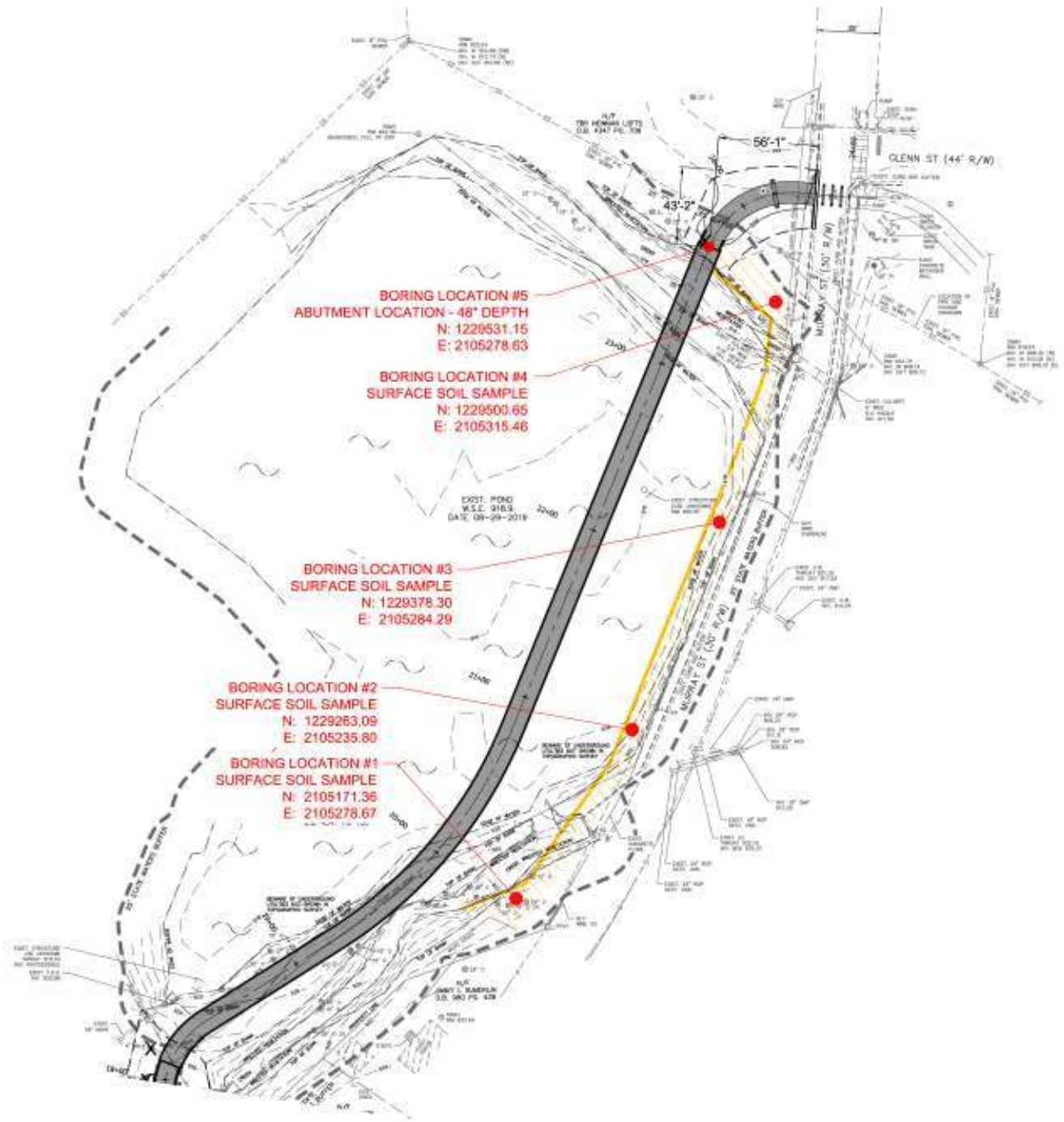

LEGEND

● SAMPLE LOCATION

CCG

Not To Scale

DATE: 3-23-20
 DWN.: WTS
 APPR.:
 REVIS.:
 PROJECT NO.:
 4976.002.20

FIGURE NO. 1
 KAIZEN COLLABORATIVE DESIGN, INC.
 NEWNAN LOFTS

SAMPLE LOCATION PLAN

ANALYTICAL TEST RESULTS



ANALYTICAL ENVIRONMENTAL SERVICES, INC.

March 24, 2020

Bill Sheppard
Chattahoochee Consulting Group, Inc
5871 New Peachtree Rd
Doraville GA 30340-1084

RE: Newnan Lofts PATH

Dear Bill Sheppard:

Order No: 2003I14

Analytical Environmental Services, Inc. received 5 samples on 3/17/2020 2:35:00 PM for the analyses presented in following report.

No problems were encountered during the analyses. Additionally, all results for the associated Quality Control samples were within EPA and/or AES established limits. Any discrepancies associated with the analyses contained herein will be noted and submitted in the form of a project Case Narrative.

AES's accreditations are as follows:

-NELAP/State of Florida Laboratory ID E87582 for analysis of Non-Potable Water, Solid & Chemical Materials, Air & Emissions Volatile Organics, and Drinking Water Microbiology & Metals, effective 07/01/19-06/30/20.

State of Georgia, Department of Natural Resources ID #800 for analysis of Drinking Water Metals, effective through 06/30/20 and Total Coliforms/ E. coli, effective 04/25/17-04/24/20.

-AIHA-LAP, LLC Laboratory ID: 100671 for Industrial Hygiene samples (Metals and PCM Asbestos), Environmental Lead (Paint, Soil, Dust Wipes, Air), and Environmental Microbiology (Fungal) Direct Examination, effective until 11/01/21.

These results relate only to the items tested as received. This report may only be reproduced in full.

If you have any questions regarding these test results, please feel free to call.

Sincerely,

Paris Masoudi

Paris Masoudi
Project Manager

CHAIN OF CUSTODY

COMPANY: <i>Chattahoochee Consulting Group, Inc.</i>			ADDRESS: <i>5871 New Peachtree Rd. Doraville, GA 30340</i>					ANALYSIS REQUESTED <i>PATH'S RCRA Metals</i>										Visit our website www.aesatlanta.com for downloadable COCs and to log in to your AES Access account.	Number of Containers										
PHONE: <i>770-457-9116</i>			EMAIL: <i>BSHEPPARD@AES-Atlanta.com</i>																										
SAMPLED BY: <i>WTS</i>			SIGNATURE: <i>W.T. Sheppard</i>					PRESERVATION (see codes)												REMARKS									
	SAMPLE ID		SAMPLED: DATE TIME		GRAB	COMPOSITE	MATRIX (see codes)	<i>I</i>	<i>I</i>																				
<i>1</i>	<i>S-1</i>		<i>3/17/20</i>	<i>12:10p.m.</i>		<input checked="" type="checkbox"/>	<i>SO</i>																					<i>2</i>	
<i>2</i>	<i>S-2</i>		<i>↓</i>	<i>12:05p.m.</i>		<input checked="" type="checkbox"/>	<i>SO</i>																						<i>2</i>
<i>3</i>	<i>S-3</i>		<i>↓</i>	<i>11:55a.m.</i>		<input checked="" type="checkbox"/>	<i>SO</i>																						<i>2</i>
<i>4</i>	<i>S-4</i>		<i>↓</i>	<i>11:26a.m.</i>		<input checked="" type="checkbox"/>	<i>SO</i>																						<i>2</i>
<i>5</i>	<i>S-5</i>		<i>↓</i>	<i>11:40a.m.</i>		<input checked="" type="checkbox"/>	<i>SO</i>																						<i>2</i>
<i>6</i>																													
<i>7</i>																													
<i>8</i>																													
<i>9</i>																													
<i>10</i>																													
<i>11</i>																													
<i>12</i>																													
<i>13</i>																													
<i>14</i>																													
RELINQUISHED BY: <i>W.T. Sheppard</i>			DATE/TIME: <i>3/17/20 2:35p.m.</i>		RECEIVED BY: <i>Laynie</i>					DATE/TIME: <i>3/17/20 14:35</i>					PROJECT INFORMATION										RECEIPT				
															<i>Newnan Lofts PATH</i>										Total # of Containers				
<i>2</i>															<i>4976.006.19</i>										<i>10</i>				
<i>3</i>															<i>Muiry Street - Newnan, GA.</i>										Turnaround Time (TAT) Request				
															<i>Bill Sheppard</i>										<input checked="" type="checkbox"/> Standard <input type="checkbox"/> 2 Business Day Rush <input type="checkbox"/> Next Business Day Rush <input type="checkbox"/> Same-Day Rush (auth req.) <input type="checkbox"/> Other _____				
															<i>Client</i>										STATE PROGRAM (if any): _____ E-mail? <input type="checkbox"/> Fax? <input type="checkbox"/> DATA PACKAGE: I <input type="radio"/> II <input type="radio"/> III <input type="radio"/> IV <input type="radio"/>				

Client: Chattahoochee Consulting Group, Inc	Client Sample ID: S-1
Project Name: Newnan Lofts PATH	Collection Date: 3/17/2020 12:10:00 PM
Lab ID: 2003I14-001	Matrix: Soil

Analyses	Result	Reporting Limit	Qual	Units	BatchID	Dilution Factor	Date Analyzed	Analyst
Total Mercury by SW7473		(SW7473)						
Mercury	0.285	0.121		mg/Kg-dry	294303	1	03/20/2020 14:19	ME
POLYAROMATIC HYDROCARBONS SW8270D		(SW3546)						
Naphthalene	BRL	400		ug/Kg-dry	294229	1	03/19/2020 16:03	HL
Acenaphthylene	BRL	400		ug/Kg-dry	294229	1	03/19/2020 16:03	HL
1-Methylnaphthalene	BRL	400		ug/Kg-dry	294229	1	03/19/2020 16:03	HL
2-Methylnaphthalene	BRL	400		ug/Kg-dry	294229	1	03/19/2020 16:03	HL
Acenaphthene	BRL	400		ug/Kg-dry	294229	1	03/19/2020 16:03	HL
Fluorene	BRL	400		ug/Kg-dry	294229	1	03/19/2020 16:03	HL
Phenanthrene	BRL	400		ug/Kg-dry	294229	1	03/19/2020 16:03	HL
Anthracene	BRL	400		ug/Kg-dry	294229	1	03/19/2020 16:03	HL
Fluoranthene	BRL	400		ug/Kg-dry	294229	1	03/19/2020 16:03	HL
Pyrene	BRL	400		ug/Kg-dry	294229	1	03/19/2020 16:03	HL
Benz(a)anthracene	BRL	400		ug/Kg-dry	294229	1	03/19/2020 16:03	HL
Chrysene	BRL	400		ug/Kg-dry	294229	1	03/19/2020 16:03	HL
Benzo(b)fluoranthene	BRL	400		ug/Kg-dry	294229	1	03/19/2020 16:03	HL
Benzo(k)fluoranthene	BRL	400		ug/Kg-dry	294229	1	03/19/2020 16:03	HL
Benzo(a)pyrene	BRL	400		ug/Kg-dry	294229	1	03/19/2020 16:03	HL
Dibenz(a,h)anthracene	BRL	400		ug/Kg-dry	294229	1	03/19/2020 16:03	HL
Benzo(g,h,i)perylene	BRL	400		ug/Kg-dry	294229	1	03/19/2020 16:03	HL
Indeno(1,2,3-cd)pyrene	BRL	400		ug/Kg-dry	294229	1	03/19/2020 16:03	HL
Surr: 2-Fluorobiphenyl	77.7	54.4-120		%REC	294229	1	03/19/2020 16:03	HL
Surr: 4-Terphenyl-d14	96.9	60.4-120		%REC	294229	1	03/19/2020 16:03	HL
Surr: Nitrobenzene-d5	79.2	51-120		%REC	294229	1	03/19/2020 16:03	HL
METALS, TOTAL SW6010D		(SW3050B)						
Arsenic	43.9	2.12		mg/Kg-dry	294211	1	03/23/2020 10:20	AJ
Barium	61.5	4.25		mg/Kg-dry	294211	1	03/23/2020 10:20	AJ
Cadmium	BRL	2.12		mg/Kg-dry	294211	1	03/23/2020 10:20	AJ
Chromium	59.8	2.12		mg/Kg-dry	294211	1	03/23/2020 10:20	AJ
Lead	45.0	4.25		mg/Kg-dry	294211	1	03/23/2020 10:20	AJ
Selenium	BRL	2.97		mg/Kg-dry	294211	1	03/23/2020 10:20	AJ
Silver	BRL	2.12		mg/Kg-dry	294211	1	03/23/2020 10:20	AJ
PERCENT MOISTURE D2216								
Percent Moisture	17.2	0		wt%	R421096	1	03/19/2020 00:00	JW

Qualifiers:

- * Value exceeds maximum contaminant level
- BRL Below reporting limit
- H Holding times for preparation or analysis exceeded
- N Analyte not NELAC certified
- B Analyte detected in the associated method blank
- > Greater than Result value

- E Estimated (value above quantitation range)
- S Spike Recovery outside limits due to matrix
- Narr See case narrative
- F Analyzed in the lab which is a deviation from the method
- < Less than Result value
- J Estimated value detected below Reporting Limit

Client: Chattahoochee Consulting Group, Inc	Client Sample ID: S-2
Project Name: Newnan Lofts PATH	Collection Date: 3/17/2020 12:05:00 PM
Lab ID: 2003I14-002	Matrix: Soil

Analyses	Result	Reporting Limit	Qual	Units	BatchID	Dilution Factor	Date Analyzed	Analyst
Total Mercury by SW7473		(SW7473)						
Mercury	BRL	0.121		mg/Kg-dry	294303	1	03/20/2020 14:27	ME
POLYAROMATIC HYDROCARBONS SW8270D		(SW3546)						
Naphthalene	830	400		ug/Kg-dry	294229	1	03/19/2020 16:28	HL
Acenaphthylene	BRL	400		ug/Kg-dry	294229	1	03/19/2020 16:28	HL
1-Methylnaphthalene	860	400		ug/Kg-dry	294229	1	03/19/2020 16:28	HL
2-Methylnaphthalene	1200	400		ug/Kg-dry	294229	1	03/19/2020 16:28	HL
Acenaphthene	BRL	400		ug/Kg-dry	294229	1	03/19/2020 16:28	HL
Fluorene	BRL	400		ug/Kg-dry	294229	1	03/19/2020 16:28	HL
Phenanthrene	1200	400		ug/Kg-dry	294229	1	03/19/2020 16:28	HL
Anthracene	BRL	400		ug/Kg-dry	294229	1	03/19/2020 16:28	HL
Fluoranthene	1400	400		ug/Kg-dry	294229	1	03/19/2020 16:28	HL
Pyrene	1100	400		ug/Kg-dry	294229	1	03/19/2020 16:28	HL
Benz(a)anthracene	640	400		ug/Kg-dry	294229	1	03/19/2020 16:28	HL
Chrysene	690	400		ug/Kg-dry	294229	1	03/19/2020 16:28	HL
Benzo(b)fluoranthene	800	400		ug/Kg-dry	294229	1	03/19/2020 16:28	HL
Benzo(k)fluoranthene	BRL	400		ug/Kg-dry	294229	1	03/19/2020 16:28	HL
Benzo(a)pyrene	540	400		ug/Kg-dry	294229	1	03/19/2020 16:28	HL
Dibenz(a,h)anthracene	BRL	400		ug/Kg-dry	294229	1	03/19/2020 16:28	HL
Benzo(g,h,i)perylene	420	400		ug/Kg-dry	294229	1	03/19/2020 16:28	HL
Indeno(1,2,3-cd)pyrene	BRL	400		ug/Kg-dry	294229	1	03/19/2020 16:28	HL
Surr: 2-Fluorobiphenyl	84.9	54.4-120		%REC	294229	1	03/19/2020 16:28	HL
Surr: 4-Terphenyl-d14	98.6	60.4-120		%REC	294229	1	03/19/2020 16:28	HL
Surr: Nitrobenzene-d5	76.8	51-120		%REC	294229	1	03/19/2020 16:28	HL
METALS, TOTAL SW6010D		(SW3050B)						
Arsenic	7.40	2.35		mg/Kg-dry	294211	1	03/23/2020 10:36	AJ
Barium	109	4.71		mg/Kg-dry	294211	1	03/23/2020 10:36	AJ
Cadmium	BRL	2.35		mg/Kg-dry	294211	1	03/23/2020 10:36	AJ
Chromium	22.9	2.35		mg/Kg-dry	294211	1	03/23/2020 10:36	AJ
Lead	110	4.71		mg/Kg-dry	294211	1	03/23/2020 10:36	AJ
Selenium	BRL	3.30		mg/Kg-dry	294211	1	03/23/2020 10:36	AJ
Silver	BRL	2.35		mg/Kg-dry	294211	1	03/23/2020 10:36	AJ
PERCENT MOISTURE D2216								
Percent Moisture	17.6	0		wt%	R421096	1	03/19/2020 00:00	JW

Qualifiers:

- * Value exceeds maximum contaminant level
- BRL Below reporting limit
- H Holding times for preparation or analysis exceeded
- N Analyte not NELAC certified
- B Analyte detected in the associated method blank
- > Greater than Result value

- E Estimated (value above quantitation range)
- S Spike Recovery outside limits due to matrix
- Narr See case narrative
- F Analyzed in the lab which is a deviation from the method
- < Less than Result value
- J Estimated value detected below Reporting Limit

Client: Chattahoochee Consulting Group, Inc	Client Sample ID: S-3
Project Name: Newnan Lofts PATH	Collection Date: 3/17/2020 11:55:00 AM
Lab ID: 2003I14-003	Matrix: Soil

Analyses	Result	Reporting Limit	Qual	Units	BatchID	Dilution Factor	Date Analyzed	Analyst
Total Mercury by SW7473		(SW7473)						
Mercury	0.182	0.118		mg/Kg-dry	294303	1	03/20/2020 14:35	ME
POLYAROMATIC HYDROCARBONS SW8270D		(SW3546)						
Naphthalene	BRL	390		ug/Kg-dry	294229	1	03/19/2020 16:52	HL
Acenaphthylene	BRL	390		ug/Kg-dry	294229	1	03/19/2020 16:52	HL
1-Methylnaphthalene	BRL	390		ug/Kg-dry	294229	1	03/19/2020 16:52	HL
2-Methylnaphthalene	BRL	390		ug/Kg-dry	294229	1	03/19/2020 16:52	HL
Acenaphthene	BRL	390		ug/Kg-dry	294229	1	03/19/2020 16:52	HL
Fluorene	BRL	390		ug/Kg-dry	294229	1	03/19/2020 16:52	HL
Phenanthrene	610	390		ug/Kg-dry	294229	1	03/19/2020 16:52	HL
Anthracene	BRL	390		ug/Kg-dry	294229	1	03/19/2020 16:52	HL
Fluoranthene	980	390		ug/Kg-dry	294229	1	03/19/2020 16:52	HL
Pyrene	840	390		ug/Kg-dry	294229	1	03/19/2020 16:52	HL
Benz(a)anthracene	450	390		ug/Kg-dry	294229	1	03/19/2020 16:52	HL
Chrysene	550	390		ug/Kg-dry	294229	1	03/19/2020 16:52	HL
Benzo(b)fluoranthene	710	390		ug/Kg-dry	294229	1	03/19/2020 16:52	HL
Benzo(k)fluoranthene	BRL	390		ug/Kg-dry	294229	1	03/19/2020 16:52	HL
Benzo(a)pyrene	BRL	390		ug/Kg-dry	294229	1	03/19/2020 16:52	HL
Dibenz(a,h)anthracene	BRL	390		ug/Kg-dry	294229	1	03/19/2020 16:52	HL
Benzo(g,h,i)perylene	BRL	390		ug/Kg-dry	294229	1	03/19/2020 16:52	HL
Indeno(1,2,3-cd)pyrene	BRL	390		ug/Kg-dry	294229	1	03/19/2020 16:52	HL
Surr: 2-Fluorobiphenyl	79.8	54.4-120		%REC	294229	1	03/19/2020 16:52	HL
Surr: 4-Terphenyl-d14	91	60.4-120		%REC	294229	1	03/19/2020 16:52	HL
Surr: Nitrobenzene-d5	74	51-120		%REC	294229	1	03/19/2020 16:52	HL
METALS, TOTAL SW6010D		(SW3050B)						
Arsenic	5.30	2.67		mg/Kg-dry	294211	1	03/23/2020 10:38	AJ
Barium	105	5.35		mg/Kg-dry	294211	1	03/23/2020 10:38	AJ
Cadmium	BRL	2.67		mg/Kg-dry	294211	1	03/23/2020 10:38	AJ
Chromium	24.2	2.67		mg/Kg-dry	294211	1	03/23/2020 10:38	AJ
Lead	267	5.35		mg/Kg-dry	294211	1	03/23/2020 10:38	AJ
Selenium	BRL	3.74		mg/Kg-dry	294211	1	03/23/2020 10:38	AJ
Silver	BRL	2.67		mg/Kg-dry	294211	1	03/23/2020 10:38	AJ
PERCENT MOISTURE D2216								
Percent Moisture	15.5	0		wt%	R421096	1	03/19/2020 00:00	JW

Qualifiers:

- * Value exceeds maximum contaminant level
- BRL Below reporting limit
- H Holding times for preparation or analysis exceeded
- N Analyte not NELAC certified
- B Analyte detected in the associated method blank
- > Greater than Result value

- E Estimated (value above quantitation range)
- S Spike Recovery outside limits due to matrix
- Narr See case narrative
- F Analyzed in the lab which is a deviation from the method
- < Less than Result value
- J Estimated value detected below Reporting Limit

Client: Chattahoochee Consulting Group, Inc	Client Sample ID: S-4
Project Name: Newnan Lofts PATH	Collection Date: 3/17/2020 11:26:00 AM
Lab ID: 2003I14-004	Matrix: Soil

Analyses	Result	Reporting Limit	Qual	Units	BatchID	Dilution Factor	Date Analyzed	Analyst
Total Mercury by SW7473		(SW7473)						
Mercury	BRL	0.116		mg/Kg-dry	294303	1	03/20/2020 14:44	ME
POLYAROMATIC HYDROCARBONS SW8270D		(SW3546)						
Naphthalene	BRL	380		ug/Kg-dry	294229	1	03/19/2020 17:16	HL
Acenaphthylene	BRL	380		ug/Kg-dry	294229	1	03/19/2020 17:16	HL
1-Methylnaphthalene	BRL	380		ug/Kg-dry	294229	1	03/19/2020 17:16	HL
2-Methylnaphthalene	BRL	380		ug/Kg-dry	294229	1	03/19/2020 17:16	HL
Acenaphthene	BRL	380		ug/Kg-dry	294229	1	03/19/2020 17:16	HL
Fluorene	BRL	380		ug/Kg-dry	294229	1	03/19/2020 17:16	HL
Phenanthrene	BRL	380		ug/Kg-dry	294229	1	03/19/2020 17:16	HL
Anthracene	BRL	380		ug/Kg-dry	294229	1	03/19/2020 17:16	HL
Fluoranthene	BRL	380		ug/Kg-dry	294229	1	03/19/2020 17:16	HL
Pyrene	BRL	380		ug/Kg-dry	294229	1	03/19/2020 17:16	HL
Benz(a)anthracene	BRL	380		ug/Kg-dry	294229	1	03/19/2020 17:16	HL
Chrysene	BRL	380		ug/Kg-dry	294229	1	03/19/2020 17:16	HL
Benzo(b)fluoranthene	BRL	380		ug/Kg-dry	294229	1	03/19/2020 17:16	HL
Benzo(k)fluoranthene	BRL	380		ug/Kg-dry	294229	1	03/19/2020 17:16	HL
Benzo(a)pyrene	BRL	380		ug/Kg-dry	294229	1	03/19/2020 17:16	HL
Dibenz(a,h)anthracene	BRL	380		ug/Kg-dry	294229	1	03/19/2020 17:16	HL
Benzo(g,h,i)perylene	BRL	380		ug/Kg-dry	294229	1	03/19/2020 17:16	HL
Indeno(1,2,3-cd)pyrene	BRL	380		ug/Kg-dry	294229	1	03/19/2020 17:16	HL
Surr: 2-Fluorobiphenyl	71.6	54.4-120		%REC	294229	1	03/19/2020 17:16	HL
Surr: 4-Terphenyl-d14	93.9	60.4-120		%REC	294229	1	03/19/2020 17:16	HL
Surr: Nitrobenzene-d5	60.7	51-120		%REC	294229	1	03/19/2020 17:16	HL
METALS, TOTAL SW6010D		(SW3050B)						
Arsenic	3.93	2.18		mg/Kg-dry	294211	1	03/23/2020 10:40	AJ
Barium	40.1	4.36		mg/Kg-dry	294211	1	03/23/2020 10:40	AJ
Cadmium	BRL	2.18		mg/Kg-dry	294211	1	03/23/2020 10:40	AJ
Chromium	46.4	2.18		mg/Kg-dry	294211	1	03/23/2020 10:40	AJ
Lead	15.0	4.36		mg/Kg-dry	294211	1	03/23/2020 10:40	AJ
Selenium	BRL	3.05		mg/Kg-dry	294211	1	03/23/2020 10:40	AJ
Silver	BRL	2.18		mg/Kg-dry	294211	1	03/23/2020 10:40	AJ
PERCENT MOISTURE D2216								
Percent Moisture	13.9	0		wt%	R421096	1	03/19/2020 00:00	JW

Qualifiers:	* Value exceeds maximum contaminant level	E Estimated (value above quantitation range)
	BRL Below reporting limit	S Spike Recovery outside limits due to matrix
	H Holding times for preparation or analysis exceeded	Narr See case narrative
	N Analyte not NELAC certified	F Analyzed in the lab which is a deviation from the method
	B Analyte detected in the associated method blank	< Less than Result value
	> Greater than Result value	J Estimated value detected below Reporting Limit

Client: Chattahoochee Consulting Group, Inc	Client Sample ID: S-5
Project Name: Newnan Lofts PATH	Collection Date: 3/17/2020 11:40:00 AM
Lab ID: 2003I14-005	Matrix: Soil

Analyses	Result	Reporting Limit	Qual	Units	BatchID	Dilution Factor	Date Analyzed	Analyst
Total Mercury by SW7473		(SW7473)						
Mercury	0.124	0.118		mg/Kg-dry	294303	1	03/20/2020 14:52	ME
POLYAROMATIC HYDROCARBONS SW8270D		(SW3546)						
Naphthalene	BRL	390		ug/Kg-dry	294229	1	03/19/2020 13:35	HL
Acenaphthylene	BRL	390		ug/Kg-dry	294229	1	03/19/2020 13:35	HL
1-Methylnaphthalene	BRL	390		ug/Kg-dry	294229	1	03/19/2020 13:35	HL
2-Methylnaphthalene	BRL	390		ug/Kg-dry	294229	1	03/19/2020 13:35	HL
Acenaphthene	BRL	390		ug/Kg-dry	294229	1	03/19/2020 13:35	HL
Fluorene	BRL	390		ug/Kg-dry	294229	1	03/19/2020 13:35	HL
Phenanthrene	BRL	390		ug/Kg-dry	294229	1	03/19/2020 13:35	HL
Anthracene	BRL	390		ug/Kg-dry	294229	1	03/19/2020 13:35	HL
Fluoranthene	BRL	390		ug/Kg-dry	294229	1	03/19/2020 13:35	HL
Pyrene	BRL	390		ug/Kg-dry	294229	1	03/19/2020 13:35	HL
Benz(a)anthracene	BRL	390		ug/Kg-dry	294229	1	03/19/2020 13:35	HL
Chrysene	BRL	390		ug/Kg-dry	294229	1	03/19/2020 13:35	HL
Benzo(b)fluoranthene	BRL	390		ug/Kg-dry	294229	1	03/19/2020 13:35	HL
Benzo(k)fluoranthene	BRL	390		ug/Kg-dry	294229	1	03/19/2020 13:35	HL
Benzo(a)pyrene	BRL	390		ug/Kg-dry	294229	1	03/19/2020 13:35	HL
Dibenz(a,h)anthracene	BRL	390		ug/Kg-dry	294229	1	03/19/2020 13:35	HL
Benzo(g,h,i)perylene	BRL	390		ug/Kg-dry	294229	1	03/19/2020 13:35	HL
Indeno(1,2,3-cd)pyrene	BRL	390		ug/Kg-dry	294229	1	03/19/2020 13:35	HL
Surr: 2-Fluorobiphenyl	71.3	54.4-120		%REC	294229	1	03/19/2020 13:35	HL
Surr: 4-Terphenyl-d14	96	60.4-120		%REC	294229	1	03/19/2020 13:35	HL
Surr: Nitrobenzene-d5	66.3	51-120		%REC	294229	1	03/19/2020 13:35	HL
METALS, TOTAL SW6010D		(SW3050B)						
Arsenic	BRL	2.91		mg/Kg-dry	294211	1	03/23/2020 10:42	AJ
Barium	30.5	5.82		mg/Kg-dry	294211	1	03/23/2020 10:42	AJ
Cadmium	BRL	2.91		mg/Kg-dry	294211	1	03/23/2020 10:42	AJ
Chromium	41.4	2.91		mg/Kg-dry	294211	1	03/23/2020 10:42	AJ
Lead	17.8	5.82		mg/Kg-dry	294211	1	03/23/2020 10:42	AJ
Selenium	BRL	4.07		mg/Kg-dry	294211	1	03/23/2020 10:42	AJ
Silver	BRL	2.91		mg/Kg-dry	294211	1	03/23/2020 10:42	AJ
PERCENT MOISTURE D2216								
Percent Moisture	15.6	0		wt%	R421096	1	03/19/2020 00:00	JW

Qualifiers:	* Value exceeds maximum contaminant level	E Estimated (value above quantitation range)
	BRL Below reporting limit	S Spike Recovery outside limits due to matrix
	H Holding times for preparation or analysis exceeded	Narr See case narrative
	N Analyte not NELAC certified	F Analyzed in the lab which is a deviation from the method
	B Analyte detected in the associated method blank	< Less than Result value
	> Greater than Result value	J Estimated value detected below Reporting Limit

SAMPLE/COOLER RECEIPT CHECKLIST

1. Client Name: Chattahoochee Consulting Group, Inc

AES Work Order Number: 2003114

2. Carrier: FedEx UPS USPS Client Courier Other _____

	Yes	No	N/A	Details	Comments
3. Shipping container/cooler received in good condition?	<input checked="" type="radio"/>	<input type="radio"/>	<input type="radio"/>	damaged <input type="checkbox"/> leaking <input type="checkbox"/> other <input type="checkbox"/>	
4. Custody seals present on shipping container?	<input type="radio"/>	<input checked="" type="radio"/>	<input type="radio"/>		
5. Custody seals intact on shipping container?	<input type="radio"/>	<input type="radio"/>	<input checked="" type="radio"/>		
6. Temperature blanks present?	<input checked="" type="radio"/>	<input type="radio"/>	<input type="radio"/>		
7. Cooler temperature(s) within limits of 0-6°C? [See item 13 and 14 for temperature recordings.]	<input checked="" type="radio"/>	<input type="radio"/>	<input type="radio"/>	Cooling initiated for recently collected samples / ice present <input type="checkbox"/>	
8. Chain of Custody (COC) present?	<input checked="" type="radio"/>	<input type="radio"/>	<input type="radio"/>		
9. Chain of Custody signed, dated, and timed when relinquished and received?	<input checked="" type="radio"/>	<input type="radio"/>	<input type="radio"/>		
10. Sampler name and/or signature on COC?	<input checked="" type="radio"/>	<input type="radio"/>	<input type="radio"/>		
11. Were all samples received within holding time?	<input checked="" type="radio"/>	<input type="radio"/>	<input type="radio"/>		
12. TAT marked on the COC?	<input checked="" type="radio"/>	<input type="radio"/>	<input type="radio"/>	If no TAT indicated, proceeded with standard TAT per Terms & Conditions. <input type="checkbox"/>	

13. Cooler 1 Temperature 4.6 °C Cooler 2 Temperature _____ °C Cooler 3 Temperature _____ °C Cooler 4 Temperature _____ °C

14. Cooler 5 Temperature _____ °C Cooler 6 Temperature _____ °C Cooler 7 Temperature _____ °C Cooler 8 Temperature _____ °C

15. Comments: _____

I certify that I have completed sections 1-15 (dated initials). AP 3/17/20

	Yes	No	N/A	Details	Comments
16. Were sample containers intact upon receipt?	<input checked="" type="radio"/>	<input type="radio"/>	<input type="radio"/>		
17. Custody seals present on sample containers?	<input type="radio"/>	<input checked="" type="radio"/>	<input type="radio"/>		
18. Custody seals intact on sample containers?	<input type="radio"/>	<input type="radio"/>	<input checked="" type="radio"/>		
19. Do sample container labels match the COC?	<input checked="" type="radio"/>	<input type="radio"/>	<input type="radio"/>	incomplete info <input type="checkbox"/> illegible <input type="checkbox"/> no label <input type="checkbox"/> other <input type="checkbox"/>	
20. Are analyses requested indicated on the COC?	<input checked="" type="radio"/>	<input type="radio"/>	<input type="radio"/>		
21. Were all of the samples listed on the COC received?	<input checked="" type="radio"/>	<input type="radio"/>	<input type="radio"/>	samples received but not listed on COC <input type="checkbox"/> samples listed on COC not received <input type="checkbox"/>	
22. Was the sample collection date/time noted?	<input checked="" type="radio"/>	<input type="radio"/>	<input type="radio"/>		
23. Did we receive sufficient sample volume for indicated analyses?	<input checked="" type="radio"/>	<input type="radio"/>	<input type="radio"/>		
24. Were samples received in appropriate containers?	<input checked="" type="radio"/>	<input type="radio"/>	<input type="radio"/>		
25. Were VOA samples received without headspace (< 1/4" bubble)?	<input type="radio"/>	<input type="radio"/>	<input checked="" type="radio"/>		
26. Were trip blanks submitted?	<input type="radio"/>	<input type="radio"/>	<input checked="" type="radio"/>	listed on COC <input type="checkbox"/> not listed on COC <input type="checkbox"/>	

27. Comments: _____

I certify that I have completed sections 16-27 (dated initials). AP 3/18/20

This section only applies to samples where pH can be checked at Sample Receipt.

	Yes	No	N/A	Details	Comments
28. Have containers needing chemical preservation been checked? *	<input type="radio"/>	<input type="radio"/>	<input checked="" type="radio"/>		
29. Containers meet preservation guidelines?	<input type="radio"/>	<input type="radio"/>	<input checked="" type="radio"/>		
30. Was pH adjusted at Sample Receipt?	<input type="radio"/>	<input type="radio"/>	<input checked="" type="radio"/>		

* Note: Certain analyses require chemical preservation but must be checked in the laboratory and not upon Sample Receipt such as Coliforms, VOCs and Oil & Grease/TPH.

I certify that I have completed sections 28-30 (dated initials). AP 3/18/20

Client: Chattahoochee Consulting Group, Inc
Project Name: Newnan Lofts PATH
Workorder: 2003I14

ANALYTICAL QC SUMMARY REPORT

BatchID: 294211

Sample ID: MB-294211	Client ID:	Units: mg/Kg	Prep Date: 03/19/2020	Run No: 421410							
SampleType: MBLK	TestCode: METALS, TOTAL SW6010D	BatchID: 294211	Analysis Date: 03/23/2020	Seq No: 9528031							
Analyte	Result	RPT Limit	SPK value	SPK Ref Val	%REC	Low Limit	High Limit	RPD Ref Val	%RPD	RPD Limit	Qual

Arsenic	BRL	2.50									
Barium	BRL	5.00									
Cadmium	BRL	2.50									
Chromium	BRL	2.50									
Lead	BRL	5.00									
Selenium	BRL	3.50									
Silver	BRL	2.50									

Sample ID: LCS-294211	Client ID:	Units: mg/Kg	Prep Date: 03/19/2020	Run No: 421410							
SampleType: LCS	TestCode: METALS, TOTAL SW6010D	BatchID: 294211	Analysis Date: 03/23/2020	Seq No: 9528032							
Analyte	Result	RPT Limit	SPK value	SPK Ref Val	%REC	Low Limit	High Limit	RPD Ref Val	%RPD	RPD Limit	Qual

Arsenic	48.89	2.50	50.00		97.8	80	120				
Barium	50.79	5.00	50.00		102	80	120				
Cadmium	49.08	2.50	50.00		98.2	80	120				
Chromium	51.36	2.50	50.00		103	80	120				
Lead	50.02	5.00	50.00		100	80	120				
Selenium	45.14	3.50	50.00		90.3	80	120				
Silver	5.734	2.50	5.000	1.471	85.3	80	120				

Sample ID: 2003I14-001BMS	Client ID: S-1	Units: mg/Kg-dry	Prep Date: 03/19/2020	Run No: 421410							
SampleType: MS	TestCode: METALS, TOTAL SW6010D	BatchID: 294211	Analysis Date: 03/23/2020	Seq No: 9528036							
Analyte	Result	RPT Limit	SPK value	SPK Ref Val	%REC	Low Limit	High Limit	RPD Ref Val	%RPD	RPD Limit	Qual

Arsenic	81.04	2.11	42.23	43.90	88.0	75	125				
Barium	99.10	4.22	42.23	61.48	89.1	75	125				
Cadmium	39.91	2.11	42.23	0.2969	93.8	75	125				
Chromium	94.81	2.11	42.23	59.75	83.0	75	125				

Qualifiers: > Greater than Result value < Less than Result value B Analyte detected in the associated method blank
 BRL Below reporting limit E Estimated (value above quantitation range) H Holding times for preparation or analysis exceeded
 J Estimated value detected below Reporting Limit N Analyte not NELAC certified R RPD outside limits due to matrix
 Rpt Lim Reporting Limit S Spike Recovery outside limits due to matrix

Client: Chattahoochee Consulting Group, Inc
Project Name: Newnan Lofts PATH
Workorder: 2003I14

ANALYTICAL QC SUMMARY REPORT

BatchID: 294211

Sample ID: 2003I14-001BMS	Client ID: S-1	Units: mg/Kg-dry	Prep Date: 03/19/2020	Run No: 421410							
SampleType: MS	TestCode: METALS, TOTAL SW6010D	BatchID: 294211	Analysis Date: 03/23/2020	Seq No: 9528036							
Analyte	Result	RPT Limit	SPK value	SPK Ref Val	%REC	Low Limit	High Limit	RPD Ref Val	%RPD	RPD Limit	Qual

Lead	81.83	4.22	42.23	44.98	87.3	75	125				
Selenium	34.70	2.96	42.23		82.2	75	125				
Silver	4.183	2.11	4.223	0.6159	84.5	75	125				

Sample ID: 2003I14-001BMSD	Client ID: S-1	Units: mg/Kg-dry	Prep Date: 03/19/2020	Run No: 421410							
SampleType: MSD	TestCode: METALS, TOTAL SW6010D	BatchID: 294211	Analysis Date: 03/23/2020	Seq No: 9528037							
Analyte	Result	RPT Limit	SPK value	SPK Ref Val	%REC	Low Limit	High Limit	RPD Ref Val	%RPD	RPD Limit	Qual

Arsenic	80.31	2.11	42.28	43.90	86.1	75	125	81.04	0.906	20	
Barium	100.0	4.23	42.28	61.48	91.1	75	125	99.10	0.920	20	
Cadmium	39.69	2.11	42.28	0.2969	93.2	75	125	39.91	0.571	20	
Chromium	87.99	2.11	42.28	59.75	66.8	75	125	94.81	7.46	20	S
Lead	85.07	4.23	42.28	44.98	94.8	75	125	81.83	3.88	20	
Selenium	33.78	2.96	42.28		79.9	75	125	34.70	2.70	20	
Silver	4.116	2.11	4.228	0.6159	82.8	75	125	4.183	1.62	20	

Qualifiers:	> Greater than Result value	< Less than Result value	B Analyte detected in the associated method blank
BRL	Below reporting limit	E Estimated (value above quantitation range)	H Holding times for preparation or analysis exceeded
J	Estimated value detected below Reporting Limit	N Analyte not NELAC certified	R RPD outside limits due to matrix
Rpt Lim	Reporting Limit	S Spike Recovery outside limits due to matrix	

Client: Chattahoochee Consulting Group, Inc
Project Name: Newnan Lofts PATH
Workorder: 2003I14

ANALYTICAL QC SUMMARY REPORT

BatchID: 294229

Sample ID: MB-294229	Client ID:	Units: ug/Kg	Prep Date: 03/19/2020	Run No: 421159							
SampleType: MBLK	TestCode: POLYAROMATIC HYDROCARBONS SW8270D	BatchID: 294229	Analysis Date: 03/19/2020	Seq No: 9524928							
Analyte	Result	RPT Limit	SPK value	SPK Ref Val	%REC	Low Limit	High Limit	RPD Ref Val	%RPD	RPD Limit	Qual

1-Methylnaphthalene	BRL	330									
2-Methylnaphthalene	BRL	330									
Acenaphthene	BRL	330									
Acenaphthylene	BRL	330									
Anthracene	BRL	330									
Benz(a)anthracene	BRL	330									
Benzo(a)pyrene	BRL	330									
Benzo(b)fluoranthene	BRL	330									
Benzo(g,h,i)perylene	BRL	330									
Benzo(k)fluoranthene	BRL	330									
Chrysene	BRL	330									
Dibenz(a,h)anthracene	BRL	330									
Fluoranthene	BRL	330									
Fluorene	BRL	330									
Indeno(1,2,3-cd)pyrene	BRL	330									
Naphthalene	BRL	330									
Phenanthrene	BRL	330									
Pyrene	BRL	330									
Surr: 2-Fluorobiphenyl	1312	0	1667		78.7	54.4	120				
Surr: 4-Terphenyl-d14	1688	0	1667		101	60.4	120				
Surr: Nitrobenzene-d5	1276	0	1667		76.6	51	120				

Sample ID: LCS-294229	Client ID:	Units: ug/Kg	Prep Date: 03/19/2020	Run No: 421159							
SampleType: LCS	TestCode: POLYAROMATIC HYDROCARBONS SW8270D	BatchID: 294229	Analysis Date: 03/19/2020	Seq No: 9524929							
Analyte	Result	RPT Limit	SPK value	SPK Ref Val	%REC	Low Limit	High Limit	RPD Ref Val	%RPD	RPD Limit	Qual

1-Methylnaphthalene	1265	330	1667		75.9	67.6	120				
2-Methylnaphthalene	1315	330	1667		78.9	66.9	120				

Qualifiers: > Greater than Result value < Less than Result value B Analyte detected in the associated method blank
 BRL Below reporting limit E Estimated (value above quantitation range) H Holding times for preparation or analysis exceeded
 J Estimated value detected below Reporting Limit N Analyte not NELAC certified R RPD outside limits due to matrix
 Rpt Lim Reporting Limit S Spike Recovery outside limits due to matrix

Client: Chattahoochee Consulting Group, Inc
Project Name: Newnan Lofts PATH
Workorder: 2003I14

ANALYTICAL QC SUMMARY REPORT

BatchID: 294229

Sample ID: LCS-294229	Client ID:	Units: ug/Kg	Prep Date: 03/19/2020	Run No: 421159							
SampleType: LCS	TestCode: POLYAROMATIC HYDROCARBONS SW8270D	BatchID: 294229	Analysis Date: 03/19/2020	Seq No: 9524929							
Analyte	Result	RPT Limit	SPK value	SPK Ref Val	%REC	Low Limit	High Limit	RPD Ref Val	%RPD	RPD Limit	Qual

Acenaphthene	1288	330	1667		77.3	67.5	120				
Acenaphthylene	1321	330	1667		79.3	66.5	120				
Anthracene	1322	330	1667		79.3	70	120				
Benz(a)anthracene	1383	330	1667		83.0	70	120				
Benzo(a)pyrene	1406	330	1667		84.4	70	120				
Benzo(b)fluoranthene	1422	330	1667		85.3	64.9	120				
Benzo(g,h,i)perylene	1440	330	1667		86.4	70	120				
Benzo(k)fluoranthene	1431	330	1667		85.9	70	120				
Chrysene	1394	330	1667		83.6	68.3	120				
Dibenz(a,h)anthracene	1441	330	1667		86.4	70	120				
Fluoranthene	1416	330	1667		85.0	70	120				
Fluorene	1408	330	1667		84.5	69.5	120				
Indeno(1,2,3-cd)pyrene	1432	330	1667		85.9	70	120				
Naphthalene	1163	330	1667		69.8	62.8	120				
Phenanthrene	1296	330	1667		77.8	70	120				
Pyrene	1340	330	1667		80.4	70	120				
Surr: 2-Fluorobiphenyl	1339	0	1667		80.3	54.4	120				
Surr: 4-Terphenyl-d14	1583	0	1667		95.0	60.4	120				
Surr: Nitrobenzene-d5	1274	0	1667		76.4	51	120				

Sample ID: 2003I14-005AMS	Client ID: S-5	Units: ug/Kg-dry	Prep Date: 03/19/2020	Run No: 421159							
SampleType: MS	TestCode: POLYAROMATIC HYDROCARBONS SW8270D	BatchID: 294229	Analysis Date: 03/19/2020	Seq No: 9524935							
Analyte	Result	RPT Limit	SPK value	SPK Ref Val	%REC	Low Limit	High Limit	RPD Ref Val	%RPD	RPD Limit	Qual

1-Methylnaphthalene	1632	390	1975		82.7	57.1	120				
2-Methylnaphthalene	1712	390	1975		86.7	54.9	120				
Acenaphthene	1634	390	1975		82.8	51.4	120				
Acenaphthylene	1643	390	1975		83.2	56.5	120				

Qualifiers:

>	Greater than Result value	<	Less than Result value	B	Analyte detected in the associated method blank
BRL	Below reporting limit	E	Estimated (value above quantitation range)	H	Holding times for preparation or analysis exceeded
J	Estimated value detected below Reporting Limit	N	Analyte not NELAC certified	R	RPD outside limits due to matrix
Rpt Lim	Reporting Limit	S	Spike Recovery outside limits due to matrix		

Client: Chattahoochee Consulting Group, Inc
Project Name: Newnan Lofts PATH
Workorder: 2003I14

ANALYTICAL QC SUMMARY REPORT

BatchID: 294229

Sample ID: 2003I14-005AMS	Client ID: S-5	Units: ug/Kg-dry	Prep Date: 03/19/2020	Run No: 421159							
SampleType: MS	TestCode: POLYAROMATIC HYDROCARBONS SW8270D	BatchID: 294229	Analysis Date: 03/19/2020	Seq No: 9524935							
Analyte	Result	RPT Limit	SPK value	SPK Ref Val	%REC	Low Limit	High Limit	RPD Ref Val	%RPD	RPD Limit	Qual

Anthracene	1728	390	1975		87.5	61.5	120				
Benz(a)anthracene	1699	390	1975		86.0	59.6	120				
Benzo(a)pyrene	1698	390	1975		86.0	63.2	120				
Benzo(b)fluoranthene	1693	390	1975		85.7	52.3	124				
Benzo(g,h,i)perylene	1731	390	1975		87.6	50.7	120				
Benzo(k)fluoranthene	1734	390	1975		87.8	59.2	120				
Chrysene	1699	390	1975		86.0	56.5	120				
Dibenz(a,h)anthracene	1788	390	1975		90.5	51.2	119				
Fluoranthene	1785	390	1975		90.4	58.1	120				
Fluorene	1726	390	1975		87.4	52.6	120				
Indeno(1,2,3-cd)pyrene	1774	390	1975		89.8	51.7	119				
Naphthalene	1547	390	1975		78.3	49.9	120				
Phenanthrene	1639	390	1975		83.0	57.4	120				
Pyrene	1669	390	1975		84.5	56.8	120				
Surr: 2-Fluorobiphenyl	1673	0	1975		84.7	54.4	120				
Surr: 4-Terphenyl-d14	1956	0	1975		99.1	60.4	120				
Surr: Nitrobenzene-d5	1493	0	1975		75.6	51	120				

Sample ID: 2003I14-005AMSD	Client ID: S-5	Units: ug/Kg-dry	Prep Date: 03/19/2020	Run No: 421159							
SampleType: MSD	TestCode: POLYAROMATIC HYDROCARBONS SW8270D	BatchID: 294229	Analysis Date: 03/19/2020	Seq No: 9524936							
Analyte	Result	RPT Limit	SPK value	SPK Ref Val	%REC	Low Limit	High Limit	RPD Ref Val	%RPD	RPD Limit	Qual

1-Methylnaphthalene	1665	390	1975		84.3	57.1	120	1632	1.99	49.8	
2-Methylnaphthalene	1615	390	1975		81.8	54.9	120	1712	5.84	54.2	
Acenaphthene	1510	390	1975		76.5	51.4	120	1634	7.89	35.6	
Acenaphthylene	1522	390	1975		77.1	56.5	120	1643	7.64	26.4	
Anthracene	1676	390	1975		84.8	61.5	120	1728	3.09	24.3	
Benz(a)anthracene	1706	390	1975		86.4	59.6	120	1699	0.394	24.8	

Qualifiers:	>	Greater than Result value	<	Less than Result value	B	Analyte detected in the associated method blank
	BRL	Below reporting limit	E	Estimated (value above quantitation range)	H	Holding times for preparation or analysis exceeded
	J	Estimated value detected below Reporting Limit	N	Analyte not NELAC certified	R	RPD outside limits due to matrix
	Rpt Lim	Reporting Limit	S	Spike Recovery outside limits due to matrix		

Client: Chattahoochee Consulting Group, Inc
Project Name: Newnan Lofts PATH
Workorder: 2003I14

ANALYTICAL QC SUMMARY REPORT

BatchID: 294229

Sample ID: 2003I14-005AMSD	Client ID: S-5	Units: ug/Kg-dry	Prep Date: 03/19/2020	Run No: 421159							
SampleType: MSD	TestCode: POLYAROMATIC HYDROCARBONS SW8270D	BatchID: 294229	Analysis Date: 03/19/2020	Seq No: 9524936							
Analyte	Result	RPT Limit	SPK value	SPK Ref Val	%REC	Low Limit	High Limit	RPD Ref Val	%RPD	RPD Limit	Qual

Analyte	Result	RPT Limit	SPK value	SPK Ref Val	%REC	Low Limit	High Limit	RPD Ref Val	%RPD	RPD Limit	Qual
Benzo(a)pyrene	1661	390	1975		84.1	63.2	120	1698	2.21	21.8	
Benzo(b)fluoranthene	1713	390	1975		86.8	52.3	124	1693	1.18	35.2	
Benzo(g,h,i)perylene	1734	390	1975		87.8	50.7	120	1731	0.160	27.7	
Benzo(k)fluoranthene	1671	390	1975		84.6	59.2	120	1734	3.71	31.8	
Chrysene	1739	390	1975		88.1	56.5	120	1699	2.34	32.7	
Dibenz(a,h)anthracene	1767	390	1975		89.5	51.2	119	1788	1.20	34.8	
Fluoranthene	1751	390	1975		88.7	58.1	120	1785	1.90	34.2	
Fluorene	1648	390	1975		83.4	52.6	120	1726	4.61	52.9	
Indeno(1,2,3-cd)pyrene	1751	390	1975		88.7	51.7	119	1774	1.30	35.2	
Naphthalene	1450	390	1975		73.4	49.9	120	1547	6.46	54.6	
Phenanthrene	1608	390	1975		81.4	57.4	120	1639	1.92	51.4	
Pyrene	1676	390	1975		84.9	56.8	120	1669	0.401	33.8	
Surr: 2-Fluorobiphenyl	1484	0	1975		75.2	54.4	120	1673	0	0	
Surr: 4-Terphenyl-d14	1964	0	1975		99.4	60.4	120	1956	0	0	
Surr: Nitrobenzene-d5	1463	0	1975		74.1	51	120	1493	0	0	

Qualifiers:	>	Greater than Result value	<	Less than Result value	B	Analyte detected in the associated method blank
	BRL	Below reporting limit	E	Estimated (value above quantitation range)	H	Holding times for preparation or analysis exceeded
	J	Estimated value detected below Reporting Limit	N	Analyte not NELAC certified	R	RPD outside limits due to matrix
	Rpt Lim	Reporting Limit	S	Spike Recovery outside limits due to matrix		

Client: Chattahoochee Consulting Group, Inc
Project Name: Newnan Lofts PATH
Workorder: 2003I14

ANALYTICAL QC SUMMARY REPORT

BatchID: 294303

Sample ID: MB-294303	Client ID:	Units: mg/Kg	Prep Date: 03/20/2020	Run No: 421322							
SampleType: MBLK	TestCode: Total Mercury by SW7473	BatchID: 294303	Analysis Date: 03/20/2020	Seq No: 9526465							
Analyte	Result	RPT Limit	SPK value	SPK Ref Val	%REC	Low Limit	High Limit	RPD Ref Val	%RPD	RPD Limit	Qual

Mercury BRL 0.100

Sample ID: LCS-294303	Client ID:	Units: mg/Kg	Prep Date: 03/20/2020	Run No: 421322							
SampleType: LCS	TestCode: Total Mercury by SW7473	BatchID: 294303	Analysis Date: 03/20/2020	Seq No: 9526466							
Analyte	Result	RPT Limit	SPK value	SPK Ref Val	%REC	Low Limit	High Limit	RPD Ref Val	%RPD	RPD Limit	Qual

Mercury 1.147 0.100 1.000 115 80 120

Sample ID: 2003161-001CMS	Client ID:	Units: mg/Kg-dry	Prep Date: 03/20/2020	Run No: 421322							
SampleType: MS	TestCode: Total Mercury by SW7473	BatchID: 294303	Analysis Date: 03/20/2020	Seq No: 9526468							
Analyte	Result	RPT Limit	SPK value	SPK Ref Val	%REC	Low Limit	High Limit	RPD Ref Val	%RPD	RPD Limit	Qual

Mercury 1.219 0.122 1.068 114 80 120

Sample ID: 2003161-001CMSD	Client ID:	Units: mg/Kg-dry	Prep Date: 03/20/2020	Run No: 421322							
SampleType: MSD	TestCode: Total Mercury by SW7473	BatchID: 294303	Analysis Date: 03/20/2020	Seq No: 9526469							
Analyte	Result	RPT Limit	SPK value	SPK Ref Val	%REC	Low Limit	High Limit	RPD Ref Val	%RPD	RPD Limit	Qual

Mercury 1.142 0.122 1.077 106 80 120 1.219 6.51 20

Qualifiers: > Greater than Result value < Less than Result value B Analyte detected in the associated method blank
 BRL Below reporting limit E Estimated (value above quantitation range) H Holding times for preparation or analysis exceeded
 J Estimated value detected below Reporting Limit N Analyte not NELAC certified R RPD outside limits due to matrix
 Rpt Lim Reporting Limit S Spike Recovery outside limits due to matrix

End of Report