



OREGON

**ADDENDUM # 1**

Date: May 30, 2019

To: All Bid Document Holders

Prepared by: City of Newport – Public Works Office

169 SW Coast Highway

Newport, OR 97365

Date: May 31, 2019

**TO ALL PLANHOLDERS:**

This addendum shall become a part of the Contract Documents as if originally included. The Bidders shall acknowledge receipt of the Addendum on the Bid Form.

The Specifications and Drawings shall be modified as required by the following items:

**SPECIFICATIONS**

AD-1 Item 1. Section 26 32 14, Page 1. DELETE paragraph 1.1 B. in its entirety.

AD-1 Item 2. Section 26 32 14, Page 1. DELETE paragraph 1.4 A.1 in its entirety.

AD-1 Item 3. Section 26 32 14, Page 2. DELETE paragraph 1.4 B.1 in its entirety.

AD-1 Item 4. Section 26 32 14, Page 3. After paragraph 2.1 A.1.d., INSERT the following, “

e. MTU Onsite Energy. “

AD-1 Item 5. Section 26 32 14, Page 13. In paragraph 3.1 A. DELETE words, “and Section 26 05 00”.

AD-1 Item 6. Section 26 32 14, Page 14. In paragraph 3.2 B. 9. REPLACE the word “Contractor” with the word “Supplier”.

**DRAWINGS**

AD-1 Item 1. Add the attached Sheet E-01.

This addendum is made part of the specifications and contract documents and shall be noted on the Bid Form. Bidders must acknowledge receipt and acceptance of this Addendum No. 1 by indicating such acknowledge in the Bid Form. FAILURE TO ACKNOWLEDGE RECEIPT AND ACCEPTANCE MAY RESULT IN REJECTION OF THE BID.

City of Newport – Public Works Office.

 Director of PW/City Engineer  
Tim Gross

DATE: May 31, 2018

ELECTRICAL HANDHOLE SCHEDULE			
HH-7E	4'-2", 4'-2", 3'-2"	UTILITY VAULT #504-LA	TOP WITH H-20 RATED, SPRING ASSISTED GALVANIZED DIAMOND PLATE DOOR WITH LOCKING LATCH, NON-SLIP COVER, AND RECESSED PADLOCKING ASSEMBLY.
HH-7S	3'-6", 3'-6", 3'-2"	UTILITY VAULT #444-LA	TOP WITH H-20 RATED, SPRING ASSISTED GALVANIZED DIAMOND PLATE DOOR WITH LOCKING LATCH, NON-SLIP COVER, AND RECESSED PADLOCKING ASSEMBLY.

- GENERAL NOTES:**
- IN GENERAL CONDUIT ROUTING IS NOT SHOWN ON THE PLANS. THE CONTRACTOR SHALL BE RESPONSIBLE FOR ROUTING ALL CONDUITS INCLUDING THOSE SHOWN ON ONE-LINES AND HOME RUNS. SEE SPECIFICATIONS FOR CONDUIT INSTALLATION REQUIREMENTS. CONDUIT ROUTINGS AND STUB-UP LOCATIONS THAT ARE SHOWN ARE APPROXIMATE, EXACT ROUTINGS SHALL BE AS REQUIRED FOR EQUIPMENT FURNISHED.
  - WHEN BRANCH CIRCUITS ARE NOT SHOWN ON THE PLANS THE CONTRACTOR SHALL FURNISH AND INSTALL ALL CONDUITS AND CONDUCTORS REQUIRED. CONDUIT AND CONDUCTOR SIZES SHALL BE THE SAME AS THE HOMERUN FOR THE BRANCH CIRCUIT.
  - SCREENING OR SHADING OF WORK IS USED TO INDICATE EXISTING COMPONENTS OR TO DE-EMPHASIZE PROPOSED IMPROVEMENTS TO HIGHLIGHT SELECTED TRADE WORK. REFER TO CONTEXT OF EACH DRAWING FOR USAGE.
  - SEE PROJECT EQUIPMENT AND PIPING SYSTEMS DRAWING FOR SYMBOLS AND ABBREVIATIONS SPECIFIC TO THE PROJECT.
  - SEE CONDUIT AND CABLE SCHEDULES ON DWG E-05.
  - SEE ELECTRICAL ONE-LINE DIAGRAMS FOR FEEDER CONDUIT AND CABLE REQUIREMENTS ON DWG E-04 AND E-05.
  - SEE CONTROL ONE-LINE DIAGRAMS FOR CONDUIT AND CABLE REQUIREMENTS RELATED TO INSTRUMENTATION AND CONTROLS EQUIPMENT ON DWG E-05.
  - ALL EXTERIOR UNDERGROUND CONDUITS SHALL BE DIRECT BURIED WITH CONCRETE CAP UNLESS OTHERWISE NOTED. SEE DETAIL 1, SHEET E-02.
  - ELECTRICAL AREA (ENCLOSURE) CLASSIFICATION FOR OUTDOOR AREAS ARE WET AND CORROSIVE AREAS (NEMA 4X).

- KEYNOTES:**
- GROUND RING. SEE GROUND SYSTEM PLAN ON SHEET E-02. INTERCEPT EXISTING GROUND CABLE AND BOND TO NEW GROUND CABLE WITH EXOTHERMICALLY WELDED CONNECTION.

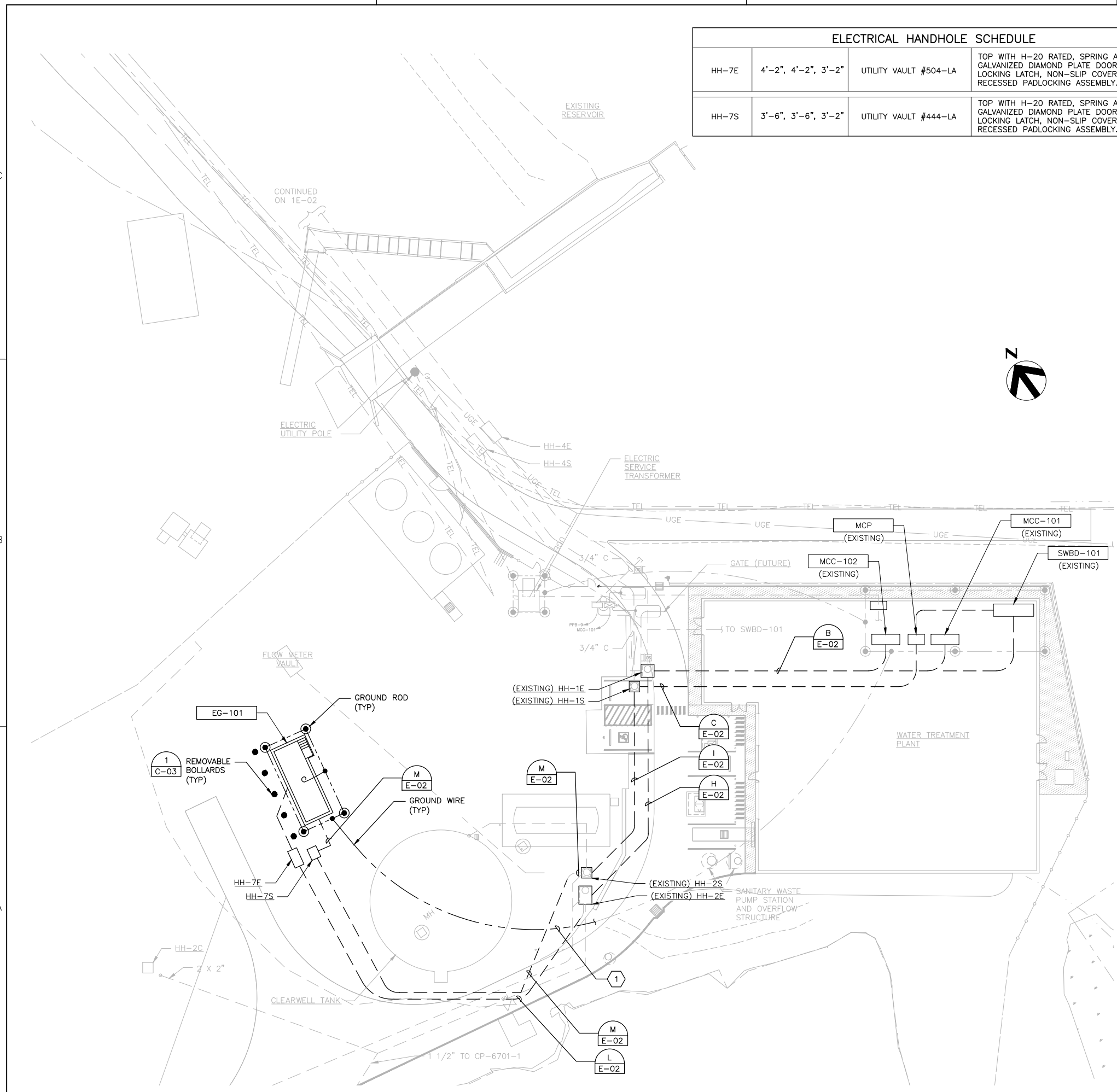

Newport, Oregon 2016

ISSUE	DATE	DESCRIPTION
0	09/16/2016	90% DESIGN
PROJECT NUMBER	000000274566	
PROJECT MANAGER	V. WINTER	
DESIGNED	D. BEST	
DRAWN	S. PAWLOWSKI	
CHECKED	D. GOTT	

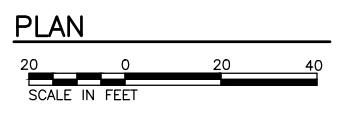
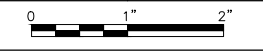

NOT FOR CONSTRUCTION

**ELECTRICAL SITE PLAN**

DATE SEPTEMBER, 2016

**E-01**

FILENAME 12\_E-01.dwg

1

2

3

4

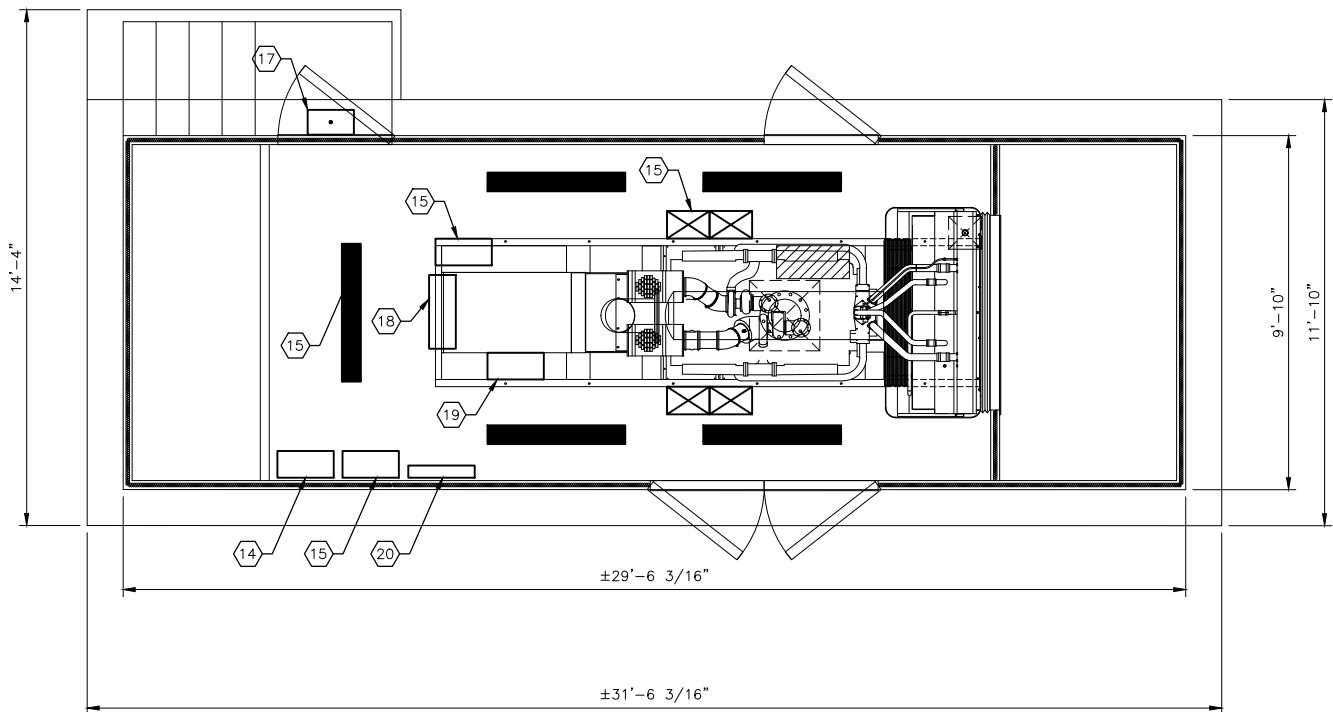

**STANDBY GENERATOR  
ENCLOSURE PLAN**  
NTS

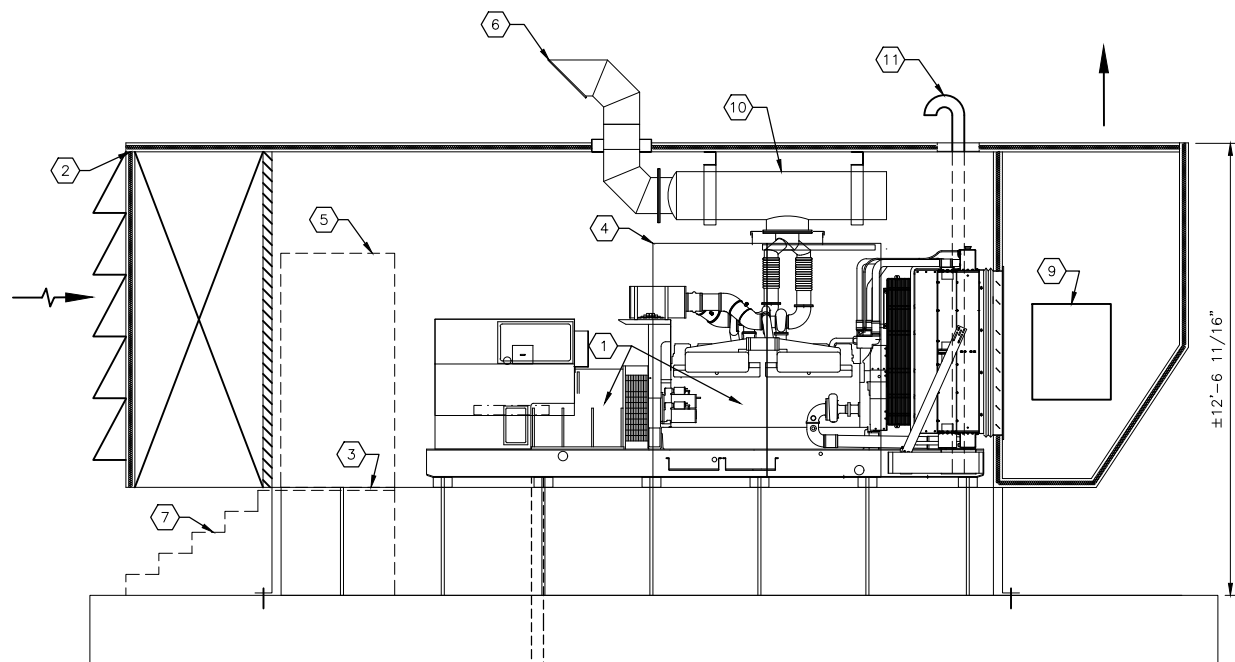

CONDUITS AND  
CONDUCTORS TO  
SWBD-101 VIA  
HH-7E AND HH-7S

**STANDBY GENERATOR  
ENCLOSURE ELEVATION**  
NTS



**MATERIALS LIST**

ITEM	QUANTITY	DESCRIPTION
①	2	STANDBY GENERATOR SET
②	1	DROP-OVER STYLE ENCLOSURE
③	4	3000 NET GALLON DOUBLE WALL FUEL TANK
④	1	DOUBLE DOORS
⑤	1	SINGLE DOOR (OPPOSITE SIDE)
⑥	2	BIRD SCREEN
⑦	1	STAIRS BEHIND
⑧	1	TANK VENT
⑨	1	HOOD ACCESS PANEL
⑩	1	SILENCER
⑪	1	FUEL TANK VENT
⑫	4	BATTERIES
⑬	1	BATTERY CHARGER
⑭	1	PANELBOARD / TRANSFORMER (PPE)
⑮	1	DIESEL FUEL MAINTENANCE SYSTEM
⑯	5	4 FOOT SEALED LED LIGHT FIXTURE
⑰	1	WALL PACK LED LIGHT FIXTURE
⑱	1	GENERATOR CONTROL PANEL
⑲	1	GENERATOR CIRCUIT BREAKER
⑳	1	SPACE HEATER



Newport, Oregon 2016

ISSUE	DATE	DESCRIPTION
0	09/16/2016	90% DESIGN

ISSUE	DATE	DESCRIPTION
PROJECT NUMBER	000000274566	
PROJECT MANAGER	V. WINTER	
DESIGNED	D. BEST	
DRAWN	S. PAWLOWSKI	
CHECKED	D. GOTT	

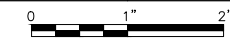

**STANDBY GENERATOR  
ENCLOSURE PLAN AND  
ELEVATION**

DATE SEPTEMBER, 2016

E-03

FILENAME 14\_E-03.dwg

NOT FOR CONSTRUCTION